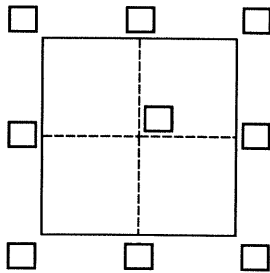

CORNER RECORD

Agency Index BK 102 PG 53Document Number CR 10663City of San Lorenzo County of Alameda, CaliforniaBrief Legal Description Monument Well at the intersection of Ashland Avenue & Ano Avenue**CORNER TYPE**

Government Corner ☐ Control ☒
Meander ☐ Property ☐
Rancho ☐ Other ☐
Date of Survey September 21, 2017

COORDINATES (Optional)N. 2077360.74 E. 6093225.88Elevation Units Metric ☐ U.S. Survey Foot ☒Horizontal Datum NAD83Zone III Epoch Date 1991.35Vertical Datum ☐ Complies with Public Resources Code §§8801-8819☐ Complies with Public Resources Code §§8890-8902PLS Act Ref.: ☐ 8765(d) ☒ 8771 ☐ 8773 ☐ Other:

Corner/
Monument: ☐ Left as found ☐ Established ☐ Rebuilt ☐ Pre-Construction
☐ Found and tagged ☒ Reestablished ☐ Referenced ☒ Post-Construction

Narrative of corner identified and monument as found, set, reset, replaced, or removed:

☒ See sheet #2 for description(s):

Monument was not disturbed during construction activities. Pre-Construction CR 9765.

Alameda County Monument ID 'CH92A7'

Brass Disk & Punch Stamped 'Alameda County Surveyor RCE 19965'

SURVEYOR'S STATEMENT

This Corner Record was prepared by me or under my direction in conformance with

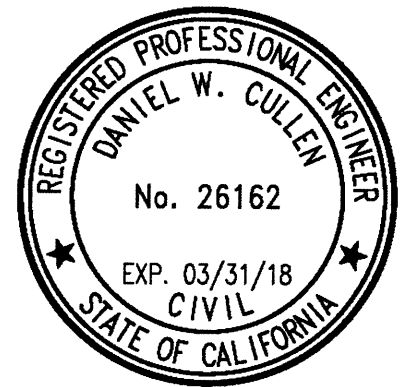
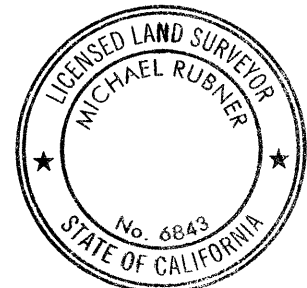
the Professional Land Surveyors' Act on September 21, 2017Signed Dan Cullen P.L.S. or R.C.E. No. 26162**COUNTY SURVEYOR'S STATEMENT**This Corner Record was received 25 SEPTEMBER 2017and examined and filed 12 OCTOBER 2017Signed Michael Rubner P.L.S. or R.C.E. No. 6843Title COUNTY SURVEYOR**County Surveyor's Comment**

Work Order No. R32107, Specification No. 2294

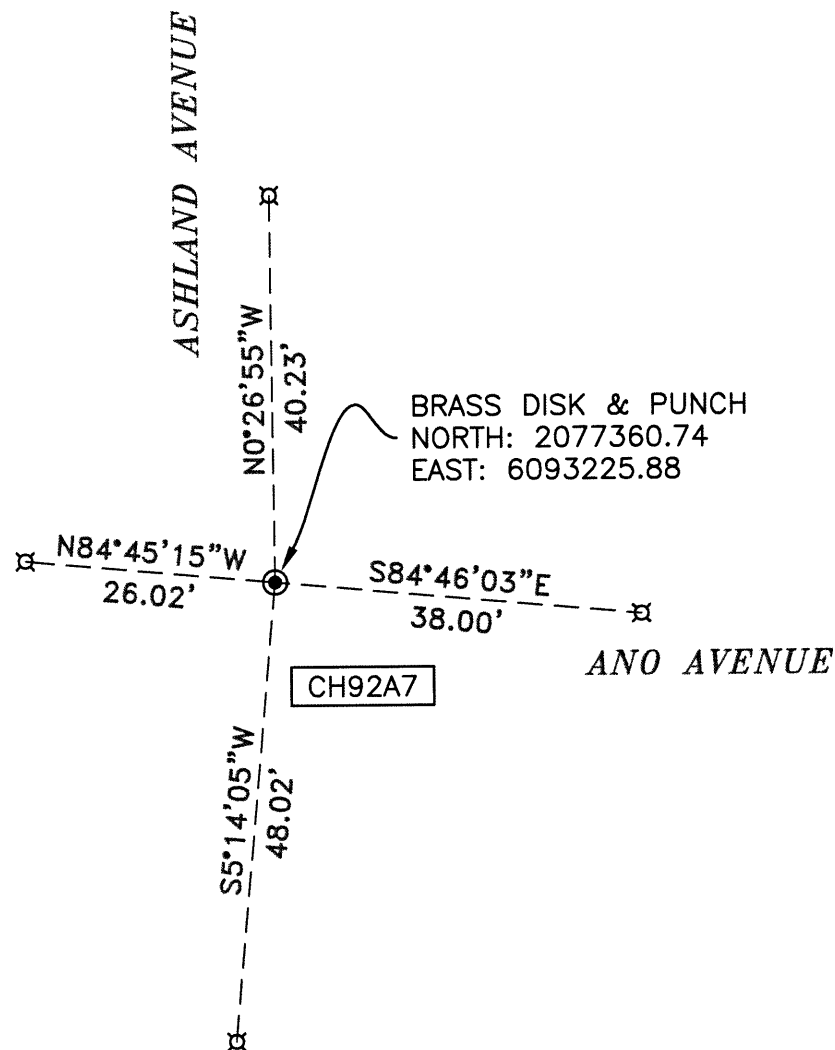
**LEGEND:**

FOUND STREET MONUMENT, STAMPED
"ALAMEDA COUNTY SURVEYOR
RCE 19965"



SET MAG NAIL IN AC

----- REFERENCE LINE

XX##X#

ALAMEDA COUNTY MONUMENT ID

NOTES:

1. DISTANCES ARE IN FEET AND DECIMALS
THEREOF.



Scale 1" = 20'

PAGE 2 OF 2

**ASHLAND AVE & ANO AVE
SAN LORENZO, CA
ALAMEDA COUNTY**



1090 Adams Street, Suite A - P.O. Box 591
Benicia, California 94510
(707) 745-3219 Fax (707) 745-9436 CSA-ENGINEERS.COM

Cullen-Sherry
& Associates, Inc.
Civil Engineering - Surveying

SCALE:	AS NOTED
DATE:	09/21/2017
DRAWN BY:	CF
CHECKED BY:	DWC
PROJECT NO:	17113