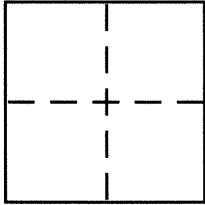

CORNER RECORDDocument Number CR 9030City of San Leandro County of Alameda, CaliforniaBrief Legal Description Monument @ Wake Ave & 139th Ave**CORNER TYPE**

Government Corner ☐ Control ☒
 Meander ☐ Property ☐
 Rancho ☐ Other ☐
 Date of Survey 10 01 14

COORDINATES (Optional)

N. 30871683.973
 E. 6088298.464
 Zone NAD83 ☒ NAD27 ☐
 NAD83 Epoch _____
 Elev. _____
 Vert. Datum: NGVD29 ☐ NAVD88 ☐
 Meas. Units: Metric ☐ Imperial ☒

Corner – Left as found ☒ Found and tagged ☐ Established ☐ Reestablished ☐ Rebuilt ☐

Identification and type of corner found: Evidence used to identify or procedure used to establish or reestablish the corner:

Per section 8771p of the Business and Professions Code
This monument was referenced prior after a construction project in the vicinity
Reference "Prior Construction" CR 8119 BE 77 pg 75

A description of the physical condition of the monument as found and as set or reset:

Found in good condition

SURVEYOR'S STATEMENT

This Corner Record was prepared by me or under my direction in conformance with the Land Surveyor's Act on 10/7/2016

Signed Joseph P. Pugh P.L.S. or R.C.E. No. 5254

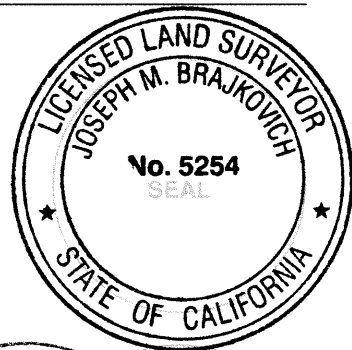
**COUNTY SURVEYOR'S STATEMENT**

This Corner Record was received 6 OCTOBER, 2016

and examined and filed 31 OCTOBER, 2016

Signed Michael Rubner P.L.S. or R.C.E. No. 6843

Title COUNTY SURVEYOR

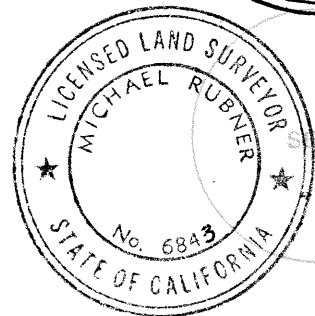

County Surveyor's Comment _____

REF.
NORTH
1"=10'

WAKE AVENUE

[NR44U1]

MONUMENT

28.84
S17°02'29"E

40.84
S75°51'02"W

139TH AVENUE

35.38
N75°49'09"E

LEGEND



MONUMENT



CUT X